

# Aurora Medical Center Grafton

## Clinical Affiliations Orientation Handbook



### ***Site Contact Information for Clinical Affiliations***

#### ***Pre-Licensure/Undergraduate***

**Patti Stockhausen, MS, RN, NPD-BC**

System-Site Nursing Professional Development Specialist,

Nursing Education and Professional Development

Clinical Affiliations Site Liaison

**Email:** [patti.stockhausen@aah.org](mailto:patti.stockhausen@aah.org)

#### **Post-Licensure/Graduate – RN to BSN, MSN, and DNP**

**Email:** [Wlnursingclinicalaffiliations@aah.org](mailto:Wlnursingclinicalaffiliations@aah.org)

# AURORA MEDICAL CENTER – GRAFTON

**132**  
BEDS

**902**  
PHYSICIANS

**59**  
SPECIALTIES

**568**  
NURSES

PART OF A  
**TOP 3**  
NOT-FOR-PROFIT HEALTH SYSTEM

**Aurora Medical Center – Grafton** was designed with an emphasis on healing, clinical excellence and comfort. The experienced team of medical professionals provides primary and tertiary specialty care services using the latest technologies for diagnosis and treatment. A nationally recognized health care provider, we offer a wide range of medical specialties in a culturally affirming and compassionate way to help all people live well.

**NATIONALLY RECOGNIZED FOR EXCELLENCE**

*Newsweek*  
World's Best Hospitals 2023

 American Heart Association  
Heart Failure Gold Plus  
Stroke Gold Plus

 healthgrades  
Patient Safety Excellence 2023  
Gastrointestinal Surgery Excellence 2023  
America's Best Prostate Surgery 2023

 2023 Environmental Excellence

*Institute for Healthcare Improvement*  
Age-Friendly Health System

**CLINICAL EXPERTISE AND SPECIALTIES**

**Heart Care**

Comprehensive heart care including complex cardiac surgery, a dedicated electrophysiology lab to treat cardiac arrhythmias, a 24/7 state-of-the-art cardiac catheterization lab and cardiac & pulmonary rehabilitation programs

**Orthopedics**

Specialists in foot & ankle, hand & upper extremity, hip resurfacing, joint replacement, musculoskeletal oncology, shoulder reconstruction, spine & back care and sports medicine

**Surgical Services**

Minimally invasive options with robot-assisted procedures using the da Vinci surgical system for general surgery, prostate cancer and thoracic surgery with less pain or blood loss and faster recovery. Center of excellence for robotic thoracic surgery

**Women's Health Care**

Complete obstetric and gynecological care, maternal fetal medicine, minimally invasive gynecological robotic surgery and 24/7 access to the highest level neonatal intensive care unit (Level II) in Ozaukee County. Our NAPBC breast center offers a multi-disciplinary team of breast surgeons, medical and radiation oncologists, plastic and reconstructive surgeons

**Emergency Care**

24/7 emergency and trauma care for life-threatening conditions like heart attacks, strokes and serious bone fractures with accreditation in geriatric emergency care

**Neuroscience**

Diagnose and treat brain, spinal cord and neuromuscular conditions, including myasthenia gravis, peripheral neuropathies, myopathies and motor neuron disease

**CARING FOR OUR COMMUNITIES**



**Safety education courses** for student athletes including CPR, First Aid and Stop the Bleed





**Improving access** by providing transportation vouchers and helping patients connect with a primary care provider



**Workforce development** including partnerships with local high schools and universities for student placement and fellowship

975 Port Washington Rd., Grafton, WI 53204 | [aurora.org/grafton](http://aurora.org/grafton) | 262-329-1000

 Aurora Health Care\* | Now part of  ADVOCATEHEALTH

z

## Clinical Experience Information

### Student/Faculty Parking & Entrance into the Hospital

- Always park in white lines in any parking lot.
- Park in the front of hospital on 1<sup>st</sup> day.
- Once you have your access card, you can then park in the lot in the back (west) side of the hospital and enter via the back entrance.
- Main hospital entrance is located at the front of the hospital facing east towards Port Washington Road.

### Badge Requests – Faculty Identification

- Nursing faculty must wear an Aurora issued Nursing Faculty badge; if you work in Aurora you cannot wear/use your teammate name badge
- Send a JPG picture of yourself to [site school liaison](mailto:site.school.liaison) to obtain nursing faculty badge.
  - Take photo with a plain background.
  - Photo should include only head and shoulders.
  - Verify photo is a JPG format and straight up and down.
- Wear your badge above your waist, in a visible location at all times.
- Instructor to send list of students to site school liaison to obtain access cards  
[patti.stockhausen@aah.org](mailto:patti.stockhausen@aah.org)
- You will be assigned an access/clam shell access card for access to utilities rooms and locker room

### Badge Requests – Student Identification

- Students are to wear their school-provided badge above the waist in a visible location at all times while on Aurora Medical Center Grafton Property.
- An access card will be supplied. Instructor to send list of students to site school liaison [Patti.Stockhausen@aah.org](mailto:Patti.Stockhausen@aah.org) to obtain access cards.

### Meeting rooms

- Not guaranteed but we will attempt to accommodate.
- Contact site school liaison to reserve rooms. [patti.stockhausen@aah.org](mailto:patti.stockhausen@aah.org)

### Food/break location

- Cafeteria on 1st floor, cash or credit card.
- No social distancing needed at tables at this time. Limited space in staff break room so please take breaks in the cafeteria.

### Belongings

- Limit any type of valuables as we have minimal space for storage on the units.

### Off unit Experiences

- We will arrange for limited off unit experiences. Contact site liaison for experiences at [Patti.stockhausen@aah.org](mailto:Patti.stockhausen@aah.org)
- Off unit will not start until a few weeks into the rotations (usually 1-2 weeks)

**Restraints (Physical and/or Chemical)**

- Students do not apply, administer, or document regarding restraints.
- Notify RN members for assistance.

**Medication**

- Nursing faculty must be at bedside for all medication administration

**Health Insurance Portability & Accountability Act (HIPAA) & Confidentiality**

- Ensure that all patient specific information is kept private and confidential.
- Do not make copies or print from the medical record.

**Access to the Patient's Electronic Medical Record (EPIC)**

- Access will be coordinated by your school Clinical Affiliations Coordinator as appropriate, and instructions will be provided to your school.
- Clinical Coordinator at each school is required to submit specific information in order to request access to the EPIC platform for each student and faculty.
- A network user ID (Network ID/AAH ID) is required to gain access to the EPIC application.
- If it is a NEW ID, an email from will be sent to the student/faculty email address to sign the confidentiality statement and activate the account. This must be done before the user may login to EPIC.
- AAH/ID and EPIC user ID Instructions: Read all directions carefully and follow specified instructions to either: Activate NEW ID per email received; Activate if no email received; Recover current Network ID/AAH ID; or reset a current Advocate Aurora Network ID password.
- EPIC requires a password reset every 90 days. You may receive an email with a reminder.

**Other Helpful Hints**

- Be cognizant of the noise level on the units
- Communicate with the staff you will be working with (i.e., tasks you can do independently, tasks that must be performed with the faculty, or tasks you are NOT permitted to do, etc.)
- Help or seek out additional learning experiences during your down time
- Help Desk number: 1-414-647-3520

**Dress Code**

- Follow your school dress code
- Look professional; school uniforms/scrubs are acceptable

**Computer/EPIC/Workday Access**

- Access will be coordinated by an Aurora school coordinator and your school's clinical placement coordinator. All access is sent to your school clinical placement coordinator when granted
- Access cannot be granted until students/instructors date of birth and last 4 of SSN is entered into My Clinical Exchange and takes a minimum of 2 weeks once needed information is in My Clinical Exchange

### Student Expectations

- Be cognizant of noise levels on the units
- Communicate with the staff you will be working with (i.e. tasks you can and cannot do)
- Offer assistance or see out additional learning experiences during your down time
- Turn cell phones off while providing patient care

## Directions to AMCG

975 Port Washington Road  
 Grafton WI 53024  
 Main number = 262-329-1000

We are located off of I-43 on exit 92.

## Nursing Departments – clinical rotations

Department Name	Description	Location & Beds	Unit Phone Number	Manager or Unit based Nursing Professional Development	Special Considerations
MS 1	Surgical	1 <sup>st</sup> floor	262-329-1800	Contact nursing unit	
MS 2	Cardiac Neuro	2 <sup>nd</sup> floor	262-329-2800	Contact nursing unit	
MS 3	Medical Oncology	3 <sup>rd</sup> floor	262-329-3800	Contact nursing unit	
MS 3W	Progressive Care Unit	3 <sup>rd</sup> floor	262-329-3900	Contact nursing unit	Limit of 6 students per clinical group
MS 4	Orthopedics	4 <sup>th</sup> floor	262-329-4800	Contact nursing unit	Limit of 7 students per clinical group
LDRP/Women's Health	LDRP/NICU	4 <sup>th</sup> floor	262-329-4700	Contact nursing unit	Limit of 6 students per clinical group

## Hospital Emergency Information (Dial 7080-5911)

### Plain Language Emergency Alert

- Following the Core Announcement, the type of actual emergency (in plain language) and location will be communicated.
  - Example: “Medical Alert – Rapid Response Team – MS 3 – Room ----312

### Facility Alert (may include but not limited to)

Fire Alarm  
Hazardous Spill  
Hospital Command  
Utility Disruption

### Weather Alert (may include but not limited to)

Severe Thunderstorm  
Tornado Warning  
Weather Alert: Snowstorm, Ice storm, Extreme Temperature

### Security Alert (may include but not limited to)

Missing Person: Adult/Child/Infant  
Building Threat  
Security Assist Team  
Perimeter Control/Lock Down  
Active Threat  
Mass Casualty

### Medical Alert (may include but not limited to)

Medical Emergency: Cardiac Arrest Adult/Pediatric; Malignant Hyperthermia, Operating Room  
First Response Team  
Rapid Response Team: STEMI, Stroke Alert, OB Alert, Trauma Alert  
Medical Emergency: Mass Transfusion

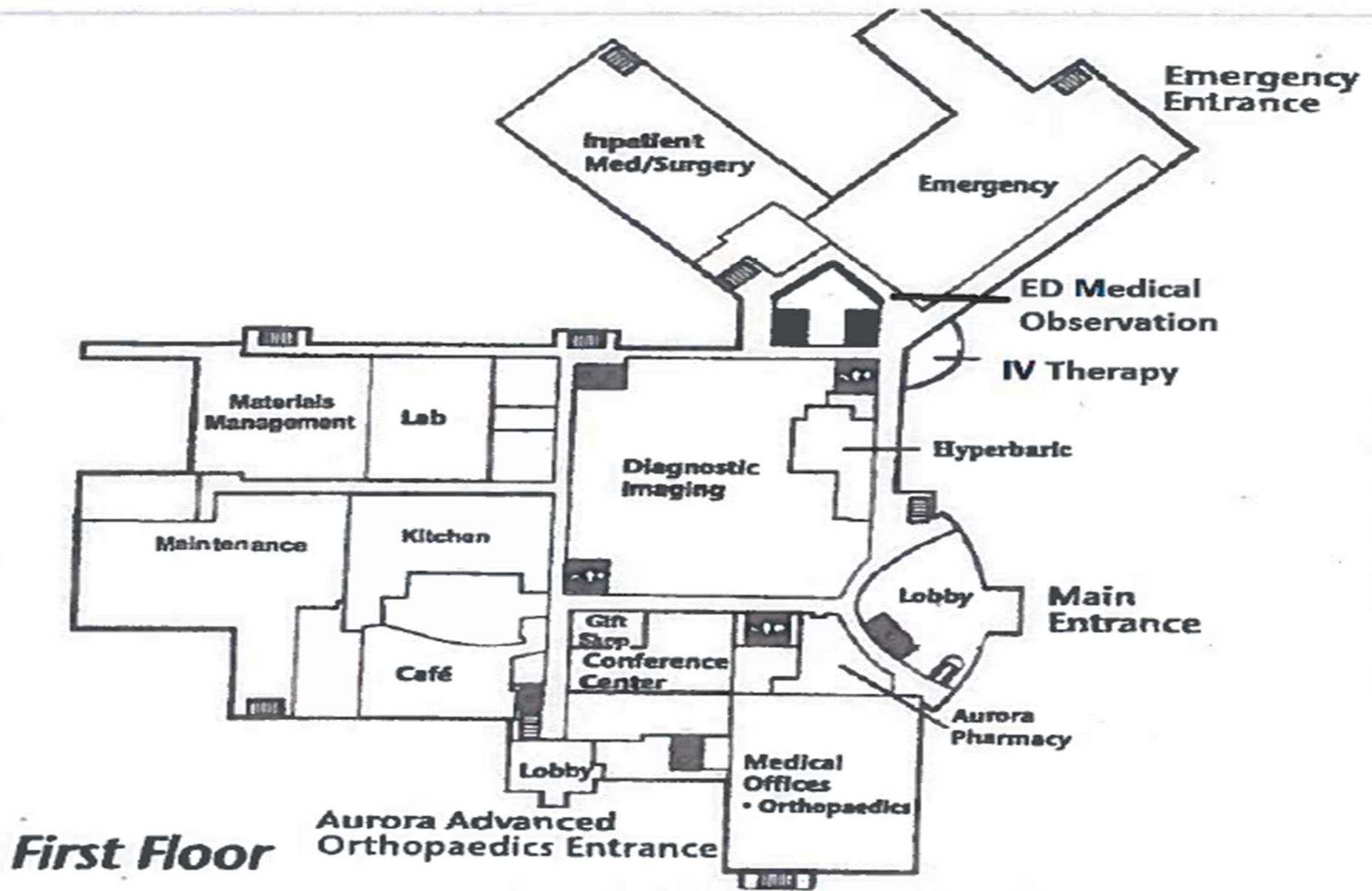

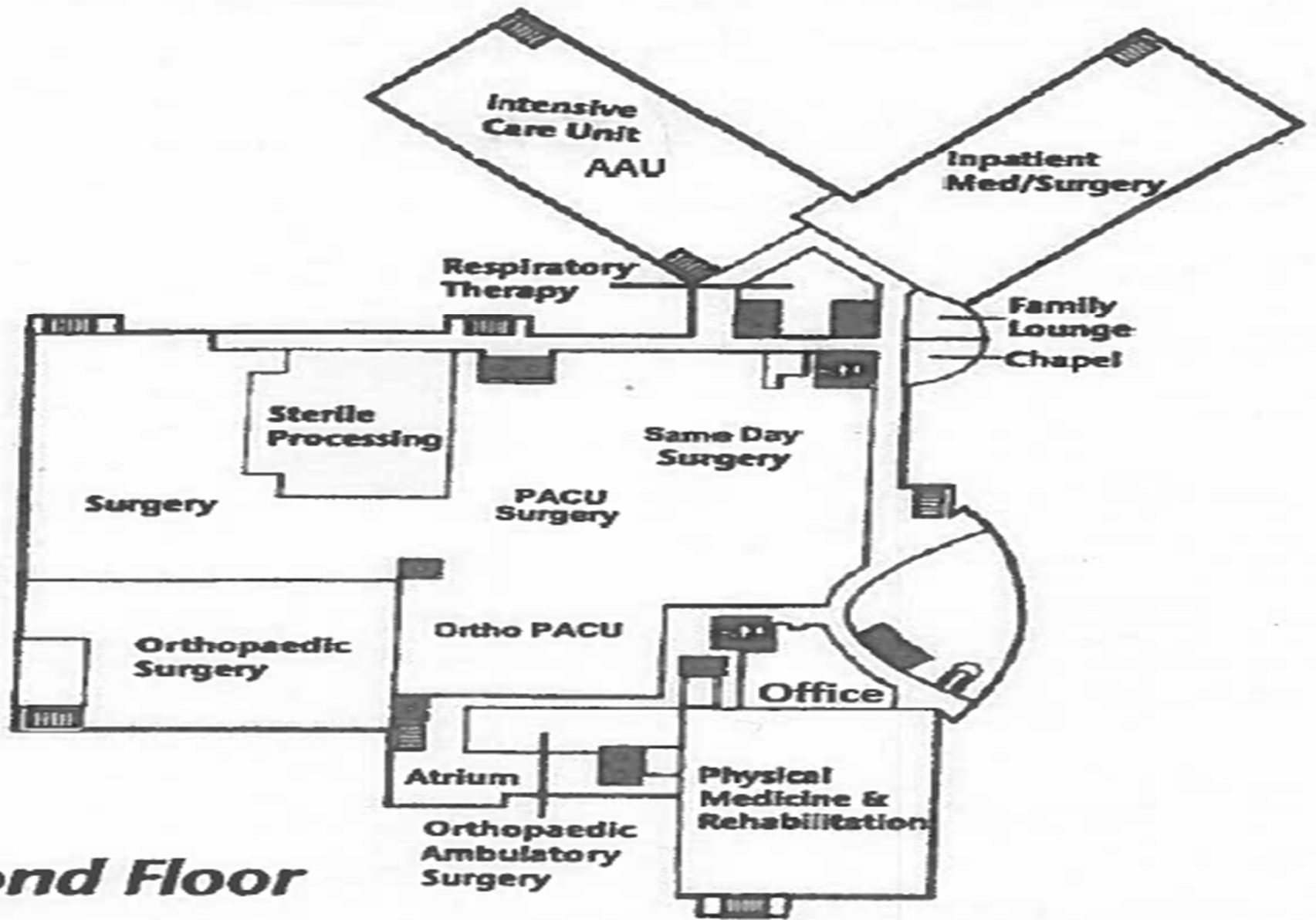

***Second Floor***



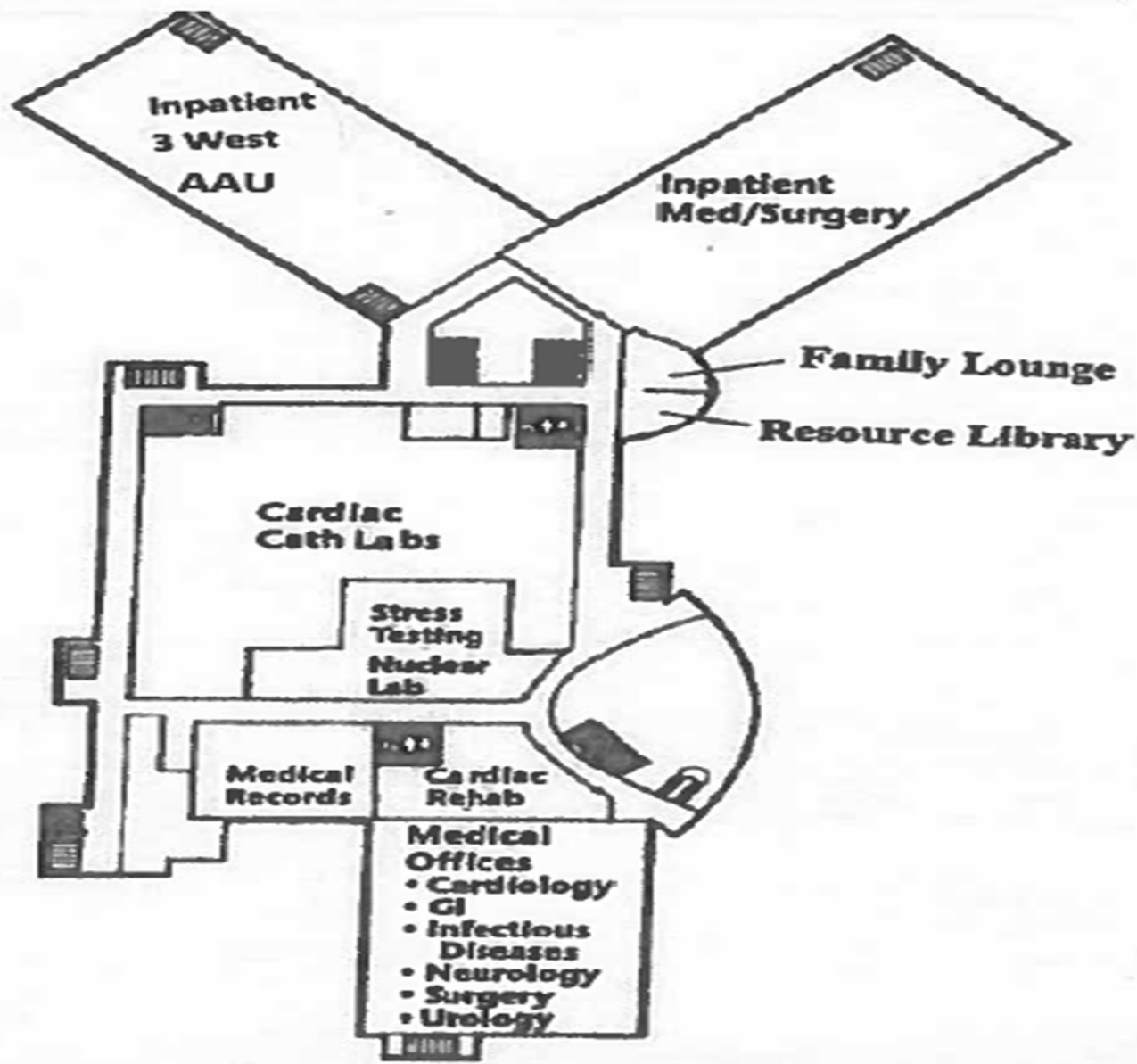

## *Third Floor*

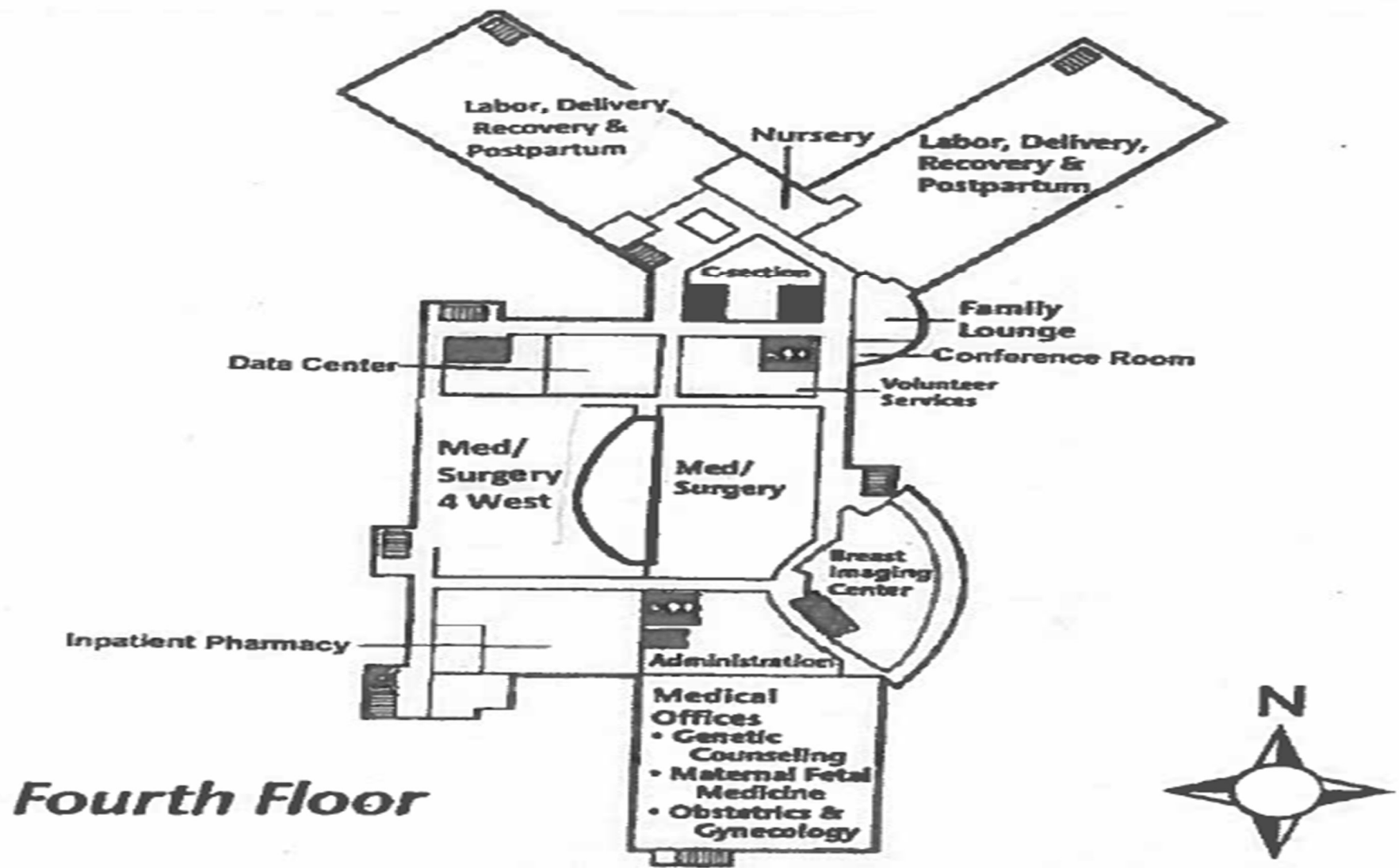

**Fourth Floor**