

Aurora Medical Center Washington County

Clinical Affiliations Orientation Handbook



AMCWC Site
Contact Information for Pre-licensure Clinical Affiliations



Jessica Baerwald MSN, RN, CEN
*Quality Improvement Coordinator,
Quality Management, Stroke Coordinator,
Site Nursing Professional Development Specialist,
Emergency Department, House Supervisors,
Sitters, and
Clinical Affiliations Liaison*

Phone: 262-670-7561

Email: jessica.baerwald@aah.org



Wendy Becker, BSN, RN, RN-BC
*Site Nursing Professional Development Generalist,
Inpatient, Wound Care & HBO, and
Clinical Affiliations Liaison*

Phone: 262-670-7332

Email: wendy.becker@aah.org

Post-Licensure/Graduate – RN to BSN, MSN, and DNP

Email: WInursingclinicalaffiliations@aah.org

Table of Contents

About Aurora Medical Center Washington County	p. 4-5
Campus Map	p. 6
First Floor Map	p. 7
Second and Third Floor Map	p. 8
Clinical Experience Requirements	p. 9

AURORA MEDICAL CENTER – WASHINGTON COUNTY

71
BEDS

569
PHYSICIANS

36
SPECIALTIES

118
NURSES

PART OF A
TOP 5
NOT-FOR-PROFIT HEALTH SYSTEM

Aurora Medical Center – Washington County in Hartford, Wisconsin is a full-service community hospital with a commitment to medical excellence, quality outcomes and safety. As a nationally recognized health care provider, we offer a wide range of medical specialties in a culturally affirming and compassionate way to help all people live well.

NATIONALLY RECOGNIZED FOR EXCELLENCE



CLINICAL EXPERTISE AND SPECIALTIES

High-Quality Emergency Services

Level III Trauma Center with board certified emergency physicians providing care 24/7. Level III accredited Geriatric ED program that ensures older adults receive high quality care

Heart Care

Comprehensive medical management with 24/7 cardiology physicians to provide coordinated and efficient emergency cardiac care

Orthopedics Services

Comprehensive orthopedics. Comprehensive sports medicine program with injury evaluations, rehabilitation, athletic training

Hyperbaric Medicine & Wound Care

One of only 45 centers nationwide to be Accredited with Distinction. Treating wounds, carbon monoxide poisoning, radiation injury and wound complications related to diabetes and led by a board-certified, medical director

Rehabilitation & Sports Medicine

Inpatient and outpatient rehab and athletic training programs to help patients return to their highest level of function following sports injuries, orthopedic or work-related injuries, traumatic illnesses or chronic conditions

Emergency Telestroke Technology

Advanced technology with immediate access to neurology specialists improving outcomes for stroke patients

CARING FOR OUR COMMUNITIES



Access to care

Supporting community health centers that care for the underserved



Behavioral health

Addressing behavioral health needs through support services in Washington County



Supporting others

Providing educational opportunities for future health care professionals and community partners

1032 E. Sumner St, Hartford, WI 53027 | aurora.org/washington | 262-670-2300



Aurora Health Care

Now part of ADVOCATEHEALTH

Campus Map

Parking - It is recommended that nursing students and instructors park in the areas labeled Teammate Parking in blue.



Aurora Medical Center
1032 E. Sumner Street
Hartford, WI 53027

First Floor

-  Restroom
-  Department Entrance
-  Elevator



Welcome to Aurora Medical Center

Wayfinding Maps & Patient Visiting Information

Aurora Medical Center
1032 E. Sumner Street
Hartford, WI 53027

aurora.org/WashingtonCounty

 Aurora Health Care

We are  Advocate  Aurora Health

Second Floor

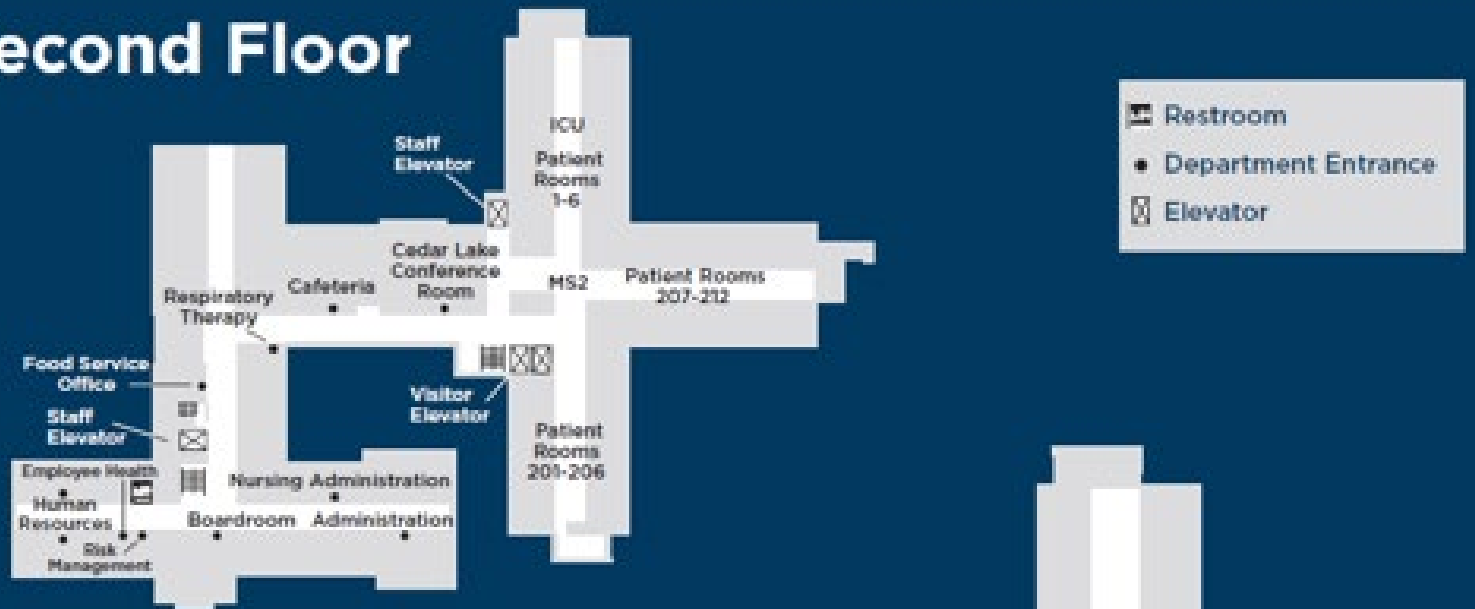

Third Floor

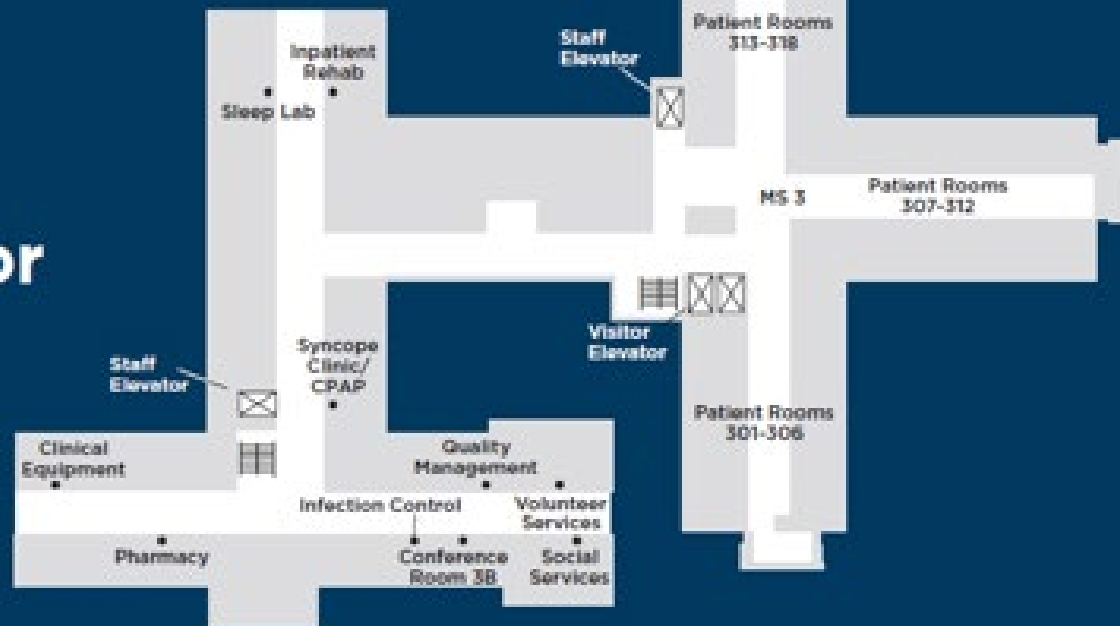

Other Clinical Experience Requirements

1. Badge Requests – Faculty Identification

- a. Students will wear their school-provided picture identification while on Aurora Medical Center Washington County property. ID badges will be worn above the waist while on Aurora Medical Center Washington County property. On-site clinical faculty will obtain an Aurora Medical Center Washington County ID badge from public safety prior to the beginning of their rotation.
- b. Nursing faculty must wear an Aurora issued Nursing Faculty badge; if you work in Aurora you cannot wear/use your teammate name badge.
- c. Send a JPG picture of yourself to [site school liaison](#) to obtain nursing faculty badge.
 1. Take photo with a plain background.
 2. Photo should include only head and shoulders.
 3. Verify photo is a JPG format and straight up and down.
- d. Always wear your badge above your waist, in a visible location.
- e. Instructor to send list of students to site school liaison to obtain access cards (if needed)

2. Cafeteria: located on 2nd floor and accepts cash or credit card. There is limited space in staff break rooms so please eat in the cafeteria or reserve a conference room.

- a. Cafeteria hours: 0700-0930, 1100-1330, 1700-1830
Grab and Go Options 0700-1830
- b. Off-shift options: unless you are an AAH team member and have set up dine and debit on your AAH employee ID badge, there are no available food options for students during the night shift except vending machines.
- c. Vending machines: accept cash or credit

3. Emergencies: push the staff assist or code button in patient rooms or dial x41 on any hospital phone.

4. Entrances: all students and clinical instructors will need to wear ID badges and complete the Safe Check app prior to arrival. Please establish a meeting area on day 1/orientation day (the main entrance is a typical meeting place). After that, clinical groups can choose to meet on the units at the start of their shift. Do not use the Surgery Center entrance.

5. Clinical cohort size is based on manager approval. Currently, due to unit size, we are limiting cohorts to 6-8 students on the unit at a time (depending on the unit). May have a larger student number enrolled, but only this number allowed on the unit at one time.

6. Clinical Workspaces:

- a. Computer classroom (4th floor) can be utilized for patient prep, if scheduled in advance or not in use. Door will need to be unlocked by Public Safety.
- b. Conference rooms can be requested for pre/post conference room, but due to site needs, these are not guaranteed. Contact the Clinical Affiliation Liaison (site contact).

7. **Off-Unit Experiences:** will be offered per instructor's requests, if possible

8. **Belongings:** limit any type of valuables as we have minimal space for storage on the units